



Porta scorrevole a due ante
Apertura laterale ad ante scorrevole, una fissa ed una apribile.

Pari de douche coulissante à deux panneaux
Ouverture latérale par un panneau coulissant sur un panneau fixe.

Two panels sliding door
Two panels door. Lateral opening with sliding panel (one fixed and one can be opened).

Frontal con puerta corredera
Frontal corredera con dos paneles, apertura lateral con hoja fija y una corredera.

2-tlg. Schiebetür
2 festen Wänden und 2 Schiebetüren.

Glijdeur met twee panelen
Lateraal openschuivende douchewand met één vast en één openschuivend paneel.

Раздвижная двустворчатая дверь
Двустворчатая раздвижная дверь, боковое открытие с раздвижной створкой, одна стационарная и другая открывающаяся.



H 195 cm. - V 6 mm.

Finitura profili

Finitions des profilés_Profiles finishing _Acabado perfiles
Profilfarbe_Profiel afwerkingen_Отделка профилей

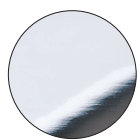

ULU
brillantato cromo
chromé brillant
brilliant chrome
aluminio cromo
Chrom glänzend
glanzend chroom
светлый блестящий хром



L01
bianco
blanc
white
blanco
Weiß
wit
белый



SAR
satinato argento
satiné argent
silver glazed satin
satinado plata
Satinier Silber
satijn Zilver
сатинованное серебро

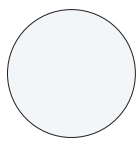

L91
bianco opaco
blanc mat
matt white
blanco mate
Matt Weiß
wit matte
белый Матовая

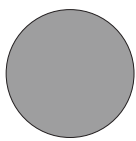

L95
grigio opaco
gris mat
matt grey
gris mate
Matt Grau
grijs matte
серый Матовая



L96
nero opaco
noir mat
matt black
negro mate
Matt Schwarz
zwart matte
черный Матовая

Finitura pannelli

Finitions des panneaux_Panels finishing _Acabado perfiles
Glasart_Paneel afwerkingen_Отделка панелей

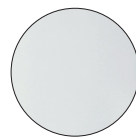

TR
trasparente
transparent
transparent
transparente
Klarglas
transparent
прозрачное



ST
Stampato
granité
frosted
estampado
Bedrucktes Glas
gemarteld
узорчатое

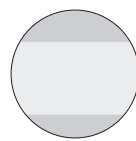

RF
trasparente con fascia Satinata
transparent bande sérigraphiée
transparent with serigraphy band
serigrafía franja
Klarglas siebdruck Band
transparent zeefdruk band
прозрачное рисунок шелкография полоса

Porta scorrevole a due ante

Paroi de douche coulissante à deux panneaux



Two panels sliding door

Frontal con puerta corredera

2-tlg. Schiebetür

Glijdeur met twee panelen

Раздвижная двустворчатая дверь

Z [cm]	Cod.	A [cm]	B [cm]	C [cm]	 [dm ³]	 [kg]	 [n°]
97-101	B0980	46,6-48,6	47,8	38	116	35	1
107-111	B0981	53,6-55,6	50,8	41	124	37	1
117-121	B0983	56,6-58,6	57,8	48	125	38	1
127-131	B0985	63,9-65,9	60,8	50	131	39	1
137-141	B0986	66,6-68,6	67,8	58	138	40	2
147-151	B0987	71,6-73,6	72,8	63	143	41	2
157-161	B0989	76,6-78,6	77,8	68	149	42	2
167-171	B0990	81,6-83,6	82,8	73	149	44	2

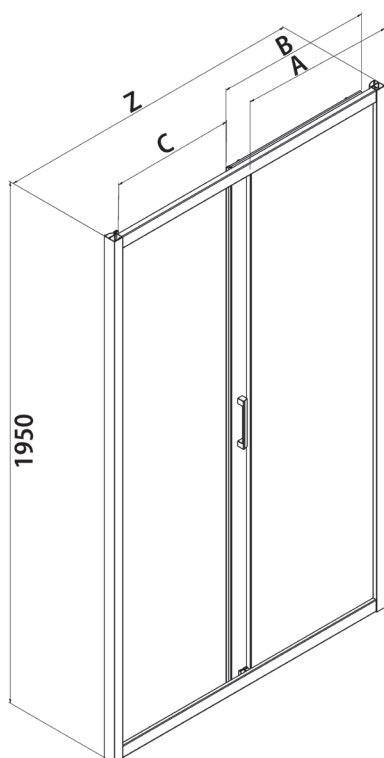

160 mm

Interasse maniglia
Empattement de la poignée
Handle wheelbase
Distancia entre ejes de la manija
Radstand handhaben
Handvat wielbasis
Колесная база ручки

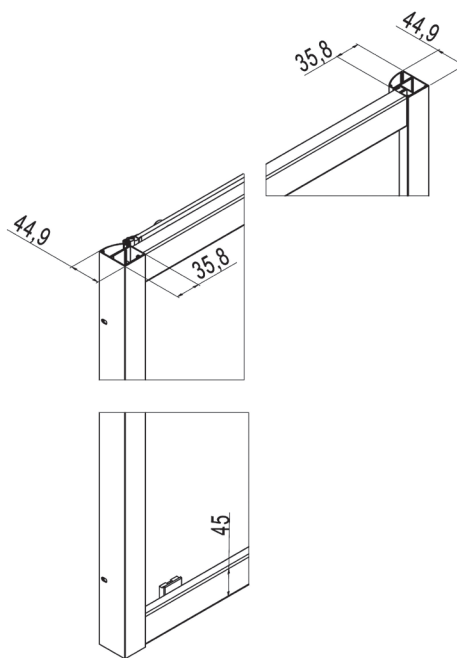
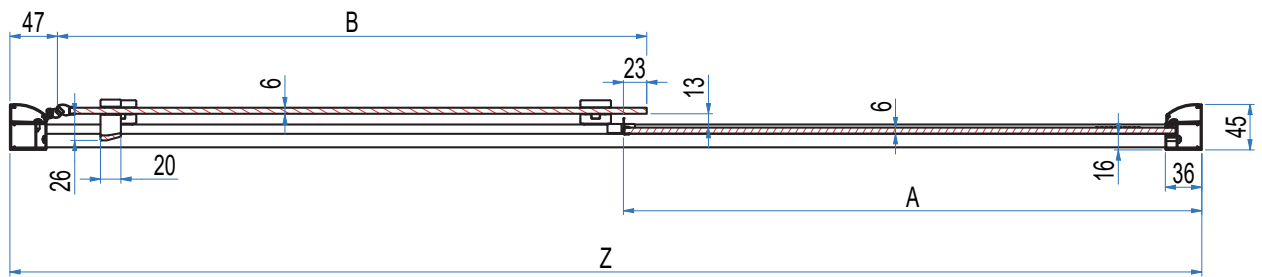

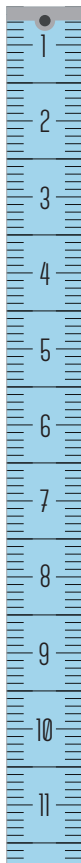

Prodotti Speciali - Produits Spéciaux - Special products - Productos Especiales - Sonderfertigungen - Maatwerk - Специальные Иродукты

MISURE LIMITE	Altezza max 200 cm.	//	Larghezza max 180 cm.	Larghezza min 80 cm.
MESURES LIMITES	Hauteur max 200 cm.	//	Largeur max 180 cm.	Largeur min 80 cm.
LIMITS OF MEASUREMENTS	Height max 200 cm.	//	Width max 180 cm.	Width min 80 cm.
MEDIDAS LIMITE	Altura max 200 cm.	//	Anchura max 180 cm.	Anchura min 80 cm.
GRENZMAßE	Höhe max 200 cm.	//	Breite max 180 cm.	Breite min 80 cm.
EXTREME MATEN	Hoogte max 200 cm.	//	Breedte max 180 cm.	Breedte min 80 cm.
ПРЕДЕЛЬНЫЕ РАЗМЕРЫ:	Макс. высота 200 см	//	Макс. ширина 180 см	Мин. ширина 80 см

	I								
	II								
	III								

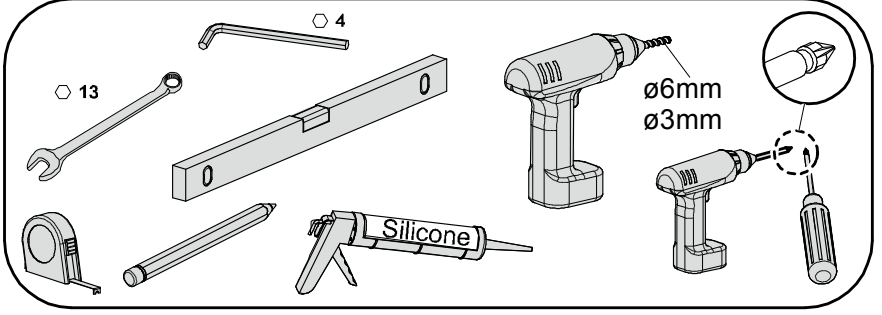
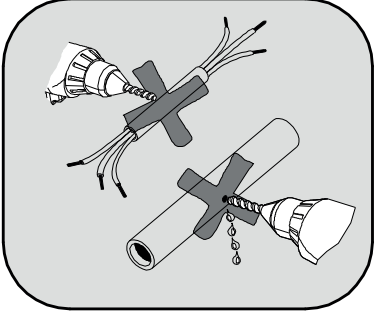
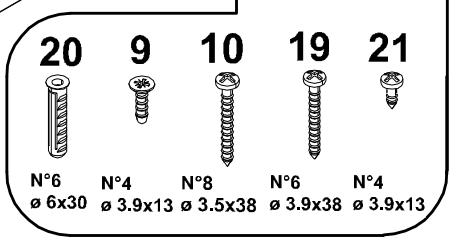
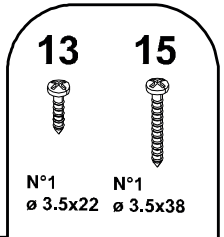
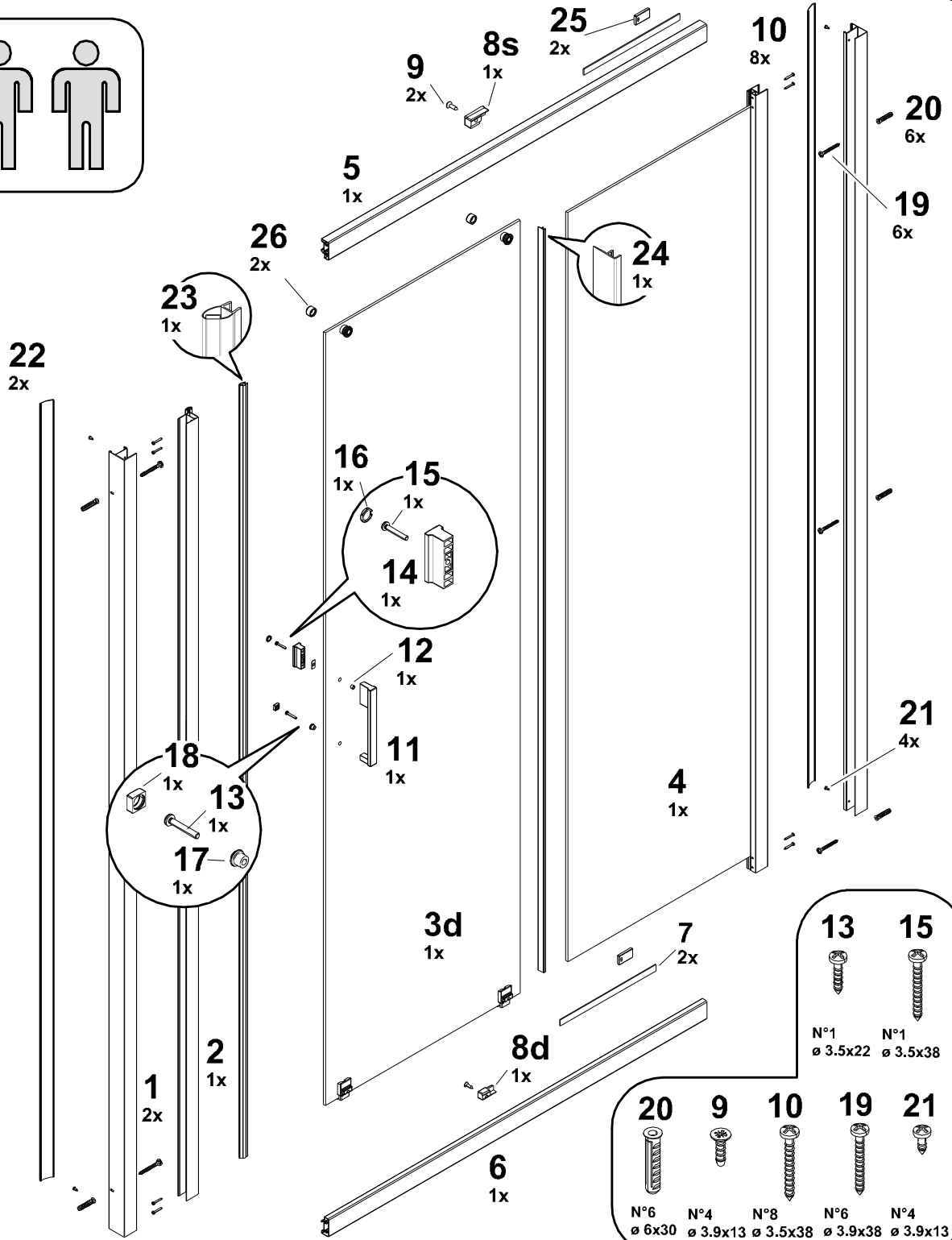
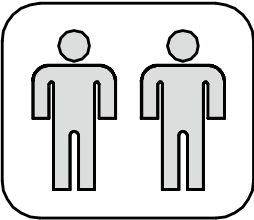

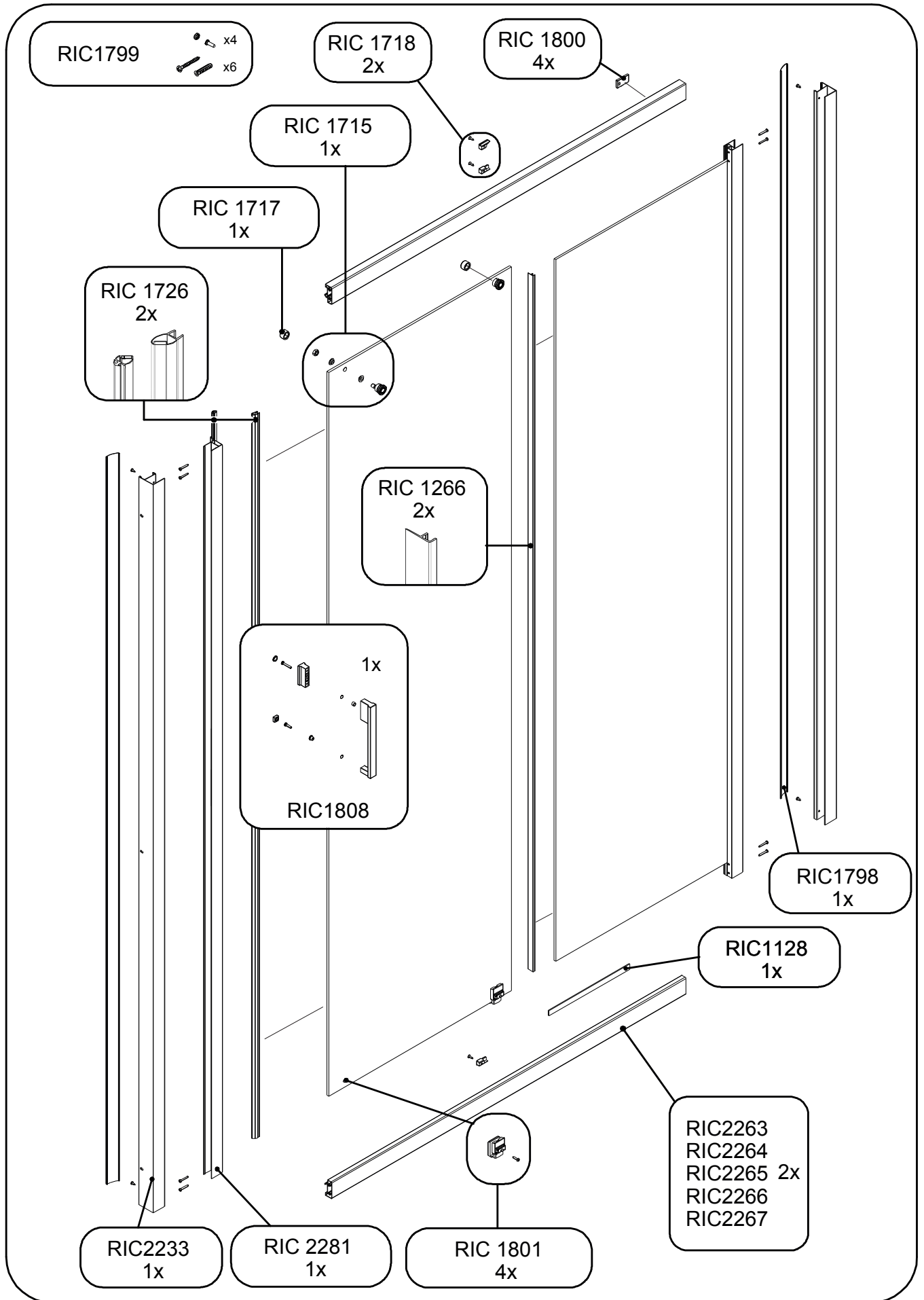

RIC 1799

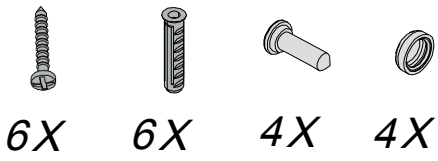

RIC 1266

2X

RIC 1726

2X

*RIC 2263*__ - B0980
*RIC 2264*__ - B0983
*RIC 2265*__ - B0986
*RIC 2266*__ - B0989
*RIC 2267*__ - B0990

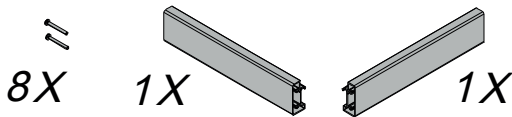

RIC 1798

1X

RIC 2281

1X

RIC 2233

1X

RIC 1808

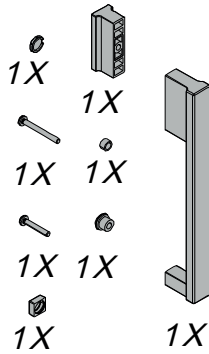

RIC 1800

2X

RIC 1718

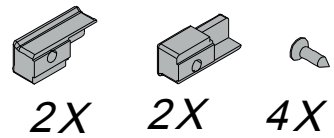

RIC 1715

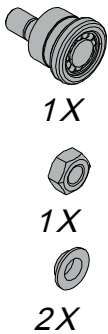

RIC 1717

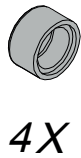

RIC 1801

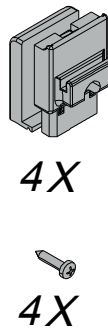

RIC 1128

